

**The value of easy installation**

One of the most valuable benefits any building product can provide is ease of installation. It impacts almost every key issue builders, contractors and homeowners consider important — especially time, labor and cost.

Compared to popular wood panel sheathings like OSB and plywood, QuietBrace™: speeds installation time, enclosing the space sooner; reduces labor costs and labor-related delays; reduces resource needs and equipment-related delays; and leads to smoother scheduling, fewer cost overruns and more efficient labor usage. It also provides advantages over insulating foam sheathings and low-end, multi-ply paperboard products. Even though these materials are easy to install, they lack structural strength and require additional corner reinforcement to meet building codes.

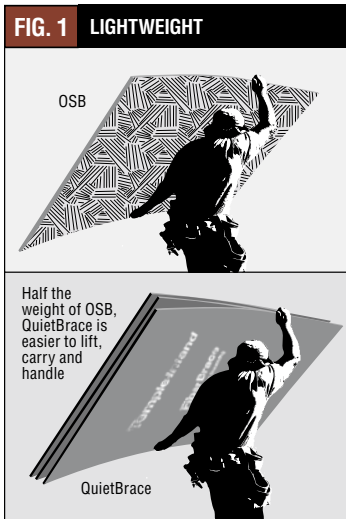

**Easy to handle**

QuietBrace is manufactured in large panels – 4' x 8', 4' x 9' and 4' x 10', and thicknesses of 1/2" and 5/8" – that are lightweight and easier to move than wood structural panels. According to the NAHB, today's average home is approximately 2,200 square feet and has an exterior wall surface of about 1,900 square feet. Allowing for windows and doors, this typical home would require 72 sheets of sheathing material.

Since a sheet of fiberboard sheathing weighs about half that of OSB or plywood, one worker can carry multiple sheets of QuietBrace at a time. It's easier to handle than wood products – especially on a ladder, a roof, or an upper floor of a structure. Plus, a faster pace of work can be maintained for longer with less exertion and fatigue. The resulting savings in time and labor costs help maximize productivity. (FIG. 1)

reduced. To further speed installation, full or partial sheets can be applied to a wall surface before cutting windows, doors and utility openings, while oversized panels can be applied to surfaces such as gable ends or dormers, allowing them to extend past the end of the wall before being trimmed even. (FIG. 2)

Cutting errors are also easier to correct, even if the application point is on a second-story surface far away from electricity. Rather than having to carry the panel back to the saw for a trim, it can be quickly and simply adjusted on the spot with a utility knife. Some builders estimate the time savings as high as 30 to 40 percent compared to wood structural panels.

QuietBrace is third-party certified to meet or exceed the building code-referenced structural fiberboard standard, ASTM C208. It is also approved for manufactured housing construction and meets HUD Wind Zone I, II and III requirements for wall sheathing.

**Easy to cut and install**

Cutting and applying structural wood sheathing is a deliberate, time-consuming process that typically includes measuring, marking, cutting, carrying and installing every board one by one. Each panel is precisely pre-cut by a power-saw operator at a dedicated saw station to fit in a specific location on the structure. Even the smallest miscalculation can cause delays.

By contrast, QuietBrace can be easily and quickly cut, almost anywhere, with a fine-toothed circular saw, a reciprocal saw or even a utility knife. Sizing is faster and more convenient and tool wear is significantly

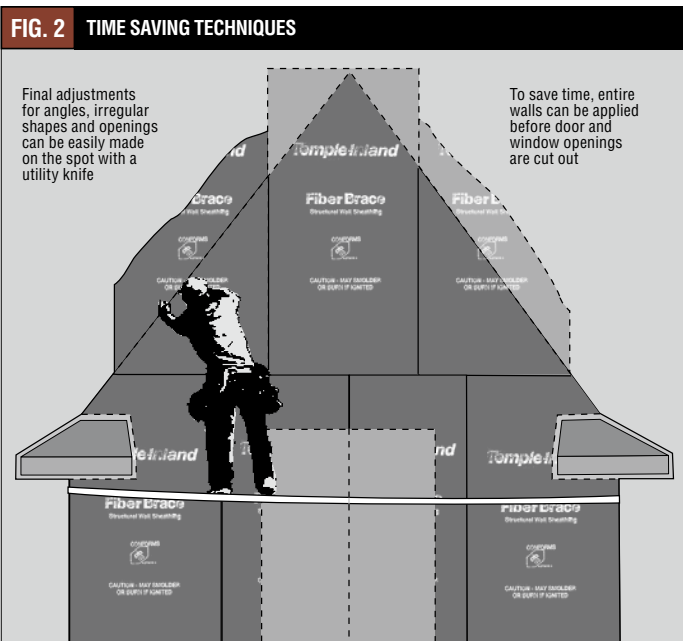

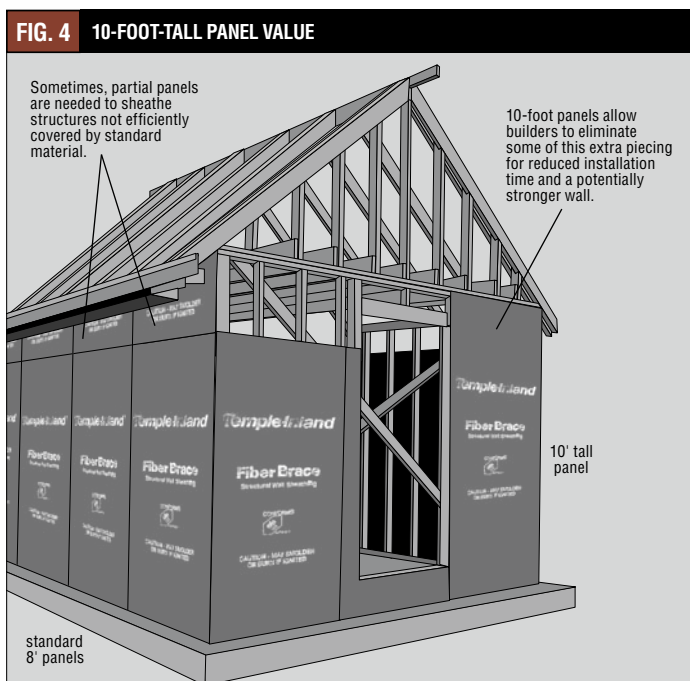
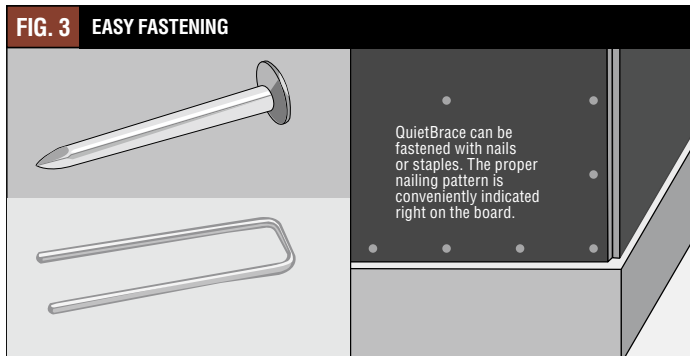

**Easy to nail or staple**

QuietBrace makes fastener spacing easier to maintain with visible indentions manufactured into the product, indicating the proper nailing pattern for both bracing and non-bracing panels.

Its asphalt-coated, interknit wood fibers grip fasteners securely and otherwise hold up well against typical jobsite handling.

Applied by hand or with a power nailer, either approved nails or staples are acceptable for code-compliant installation. A range of shear values can be delivered with the right combination of fastener length and spacing. (FIG. 3)

**Even more benefits**

QuietBrace comes in 8', 9' and 10' lengths. This is particularly valuable for accommodating wood frame construction, taller ceiling heights and multi-story designs because it allows a single panel to span the entire distance from the first floor base plate or rim joist to the base plate or rim joist for the second floor. Larger panels help create a potentially stronger wall by tying together more of the surface at once. Fewer pieces mean fewer seams, which result in the finished surface being a more effective barrier to air and moisture. (FIG. 4)

QuietBrace has also passed independent testing of its performance as part of a weather-resistant barrier. Installed with approved foil seam tapes, it was tested according to ASTM E331 and successfully passed with no water passing through QuietBrace or the joint.

Faster and easier to install than a separate house wrap, its six-sided asphalt coating provides superior protection against water absorption when stored onsite prior to installation and against moisture intrusion during the life of the structure.

**Versatile and cost-efficient**

No other exterior sheathing makes it so easy to install such a valuable, high-performance combination of features. QuietBrace saves time, labor, materials and cost while delivering structural strength, moisture permeability, extra insulation value, noise control, weather resistance and exceptional efficiency. All in one product. All in one application.