

When handled and installed according to these installation guidelines, SoundChoice® is effective for significantly reducing sound transfer from one environment to the next through walls and ceilings.

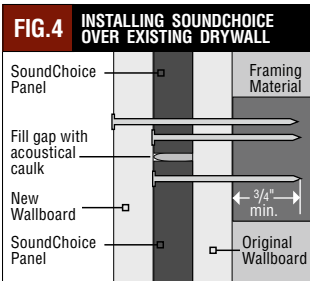
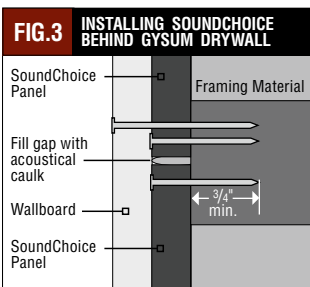
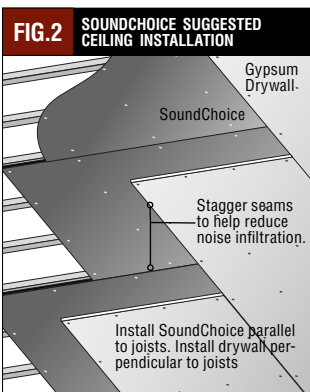
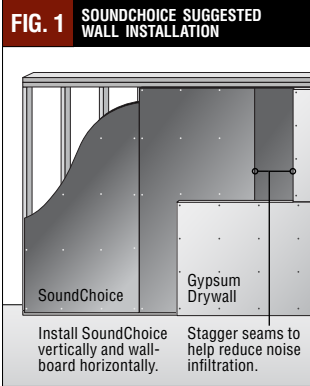

SoundChoice® installation recommendations

Plan for cutouts

Prior to applying SoundChoice®, make sure all electrical boxes and ducts are installed so they will be flush with the finished wall surface. If mud rings are to be used on electrical boxes, install them prior to SoundChoice or drywall. Carefully measure and cut all necessary openings before fastening SoundChoice to framing members.

Wall installation

On walls, apply SoundChoice vertically to wall framing with 1 1/4" drywall nails or screws spaced every 24" o.c. along the perimeter and on intermediate studs within the sheet. See (FIG. 1) After installation, seal seams and openings with acoustical caulk.

Drywall installation

Install drywall panels over SoundChoice perpendicular to the framing members (horizontally), being careful to stagger joints so the wallboard seams do not line up with the seams of SoundChoice.

Ceiling installation

On ceilings, SoundChoice should be attached with its longest dimension parallel to the joists. Fasten each panel to the joists with drywall nails or screws that are at least 1 1/4" long and spaced every 24" o.c. along the outer perimeter and on intermediate framing within each sheet. Fasteners should be placed no closer than 3/8" from the edge of each panel. See (FIG. 2)

Use full sheets whenever possible to minimize joints, and butt panels together lightly but do not force fit.

Nails or screws should be long enough to penetrate into framing members at least 3/4". See (FIG. 3)

Applying SoundChoice over existing drywall

Cutouts and penetrations

Prior to applying SoundChoice, extend all electrical boxes and ducts to be flush with the new finished wall surface. If mud rings are to be used on electrical boxes, install them prior to SoundChoice or drywall. Carefully measure and cut all necessary openings before fastening SoundChoice to framing members.

Panel orientation

Apply SoundChoice's long dimension parallel to framing members over existing gypsum using fasteners long enough to penetrate framing members at least 3/4". See (FIG. 4)

Install drywall panels over SoundChoice with the drywall long dimension perpendicular to the framing members—being careful to stagger joints so the wallboard seams do not line up with the seams of SoundChoice.

Use full sheets whenever possible to minimize joints. Seal all seams with acoustical caulk.

Limitations/Considerations

- SoundChoice is not designed as an interior wall surface.
- Do not paint, add texture or attach wallpaper directly to SoundChoice.
- Adding SoundChoice to your wall assembly will increase the overall thickness, affecting other components such as window and door jambs.
- SoundChoice is not intended to be a substrate for direct flooring attachment.

Storage

Store SoundChoice flat on stringers with at least 6 inches of clearance between each stack of units, away from standing water.

Cutting

Use a utility knife or fine-toothed power saw. Panels can be cut prior to installation or applied first and trimmed in place when appropriate.

Contact Temple-Inland for special construction instructions not covered in this publication.

Typical SoundChoice Applications

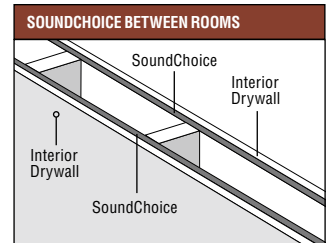

Using layers of SoundChoice between the framing and the wallboard on both sides of a divider wall is a great way to keep sound in one room from spreading to the other adjacent room.

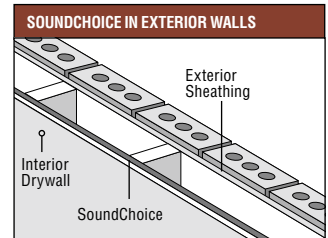

Adding SoundChoice to exterior walls between the framing and the interior wallboard is a very effective way to reduce noise. The SoundChoice layer interrupts the vibration transfer from exterior noises, reducing the volume of exterior noise.

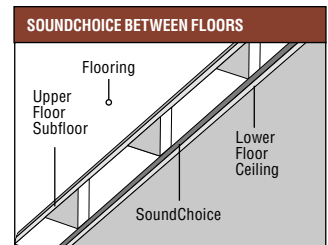

Inserting a layer of SoundChoice between ceiling joists and the ceiling wallboard is an effective means of reducing the unwanted transfer of noise from an upper floor to the floor below.